

# NANLITE

lumo Phone Ring Light (MagSafe Compatible)

## USER MANUAL

Version: V1.3  
2025-06-26

# Revision History

Version	Date (Y-M-D)	Note
V1.0	2025-01-23	File First Publish
V1.1	2025-04-29	Minor adjustments
V1.2	2025-05-14	Includes update and minor adjustments
V1.3	2025-06-26	Add a safety instruction

# Contents

1. Introduction .....	1
2. Product Overview .....	2
2.1. Product Layout .....	2
2.2. Specifications .....	3
2.3. Includes .....	4
3. Safety Instructions .....	5
4. Operating Instructions .....	6
4.1. Magnetic Installation .....	6
4.2. Lighting Control .....	6
4.2.1. Brightness Adjustment .....	6
4.2.2. Color Temperature Adjustment .....	6
4.3. Lighting .....	7
4.4. Other Usages .....	8
4.5. Charging Instructions .....	9
4.6. Indicator Instructions .....	9
5. Troubleshooting for Common Issues .....	10

# 1. Introduction

Thank you for purchasing the Nanlite product – lumo!

The lumo is a portable magnetic phone ring light designed for various scenarios such as selfies, live streaming, online meeting, and product photography. Featuring multi-angle rotation, adjustable brightness and color temperature across three levels, it offers versatile lighting to create a variety of atmospheres. Compact and lightweight, it comes with a USB-C charging port and magnetic design, bringing flexible lighting for any moment.

Before using lumo, please read this manual carefully to ensure you can fully utilize all the features. Hope it can work with you to create more brilliant results together.

## 2. Product Overview

### 2.1. Product Layout

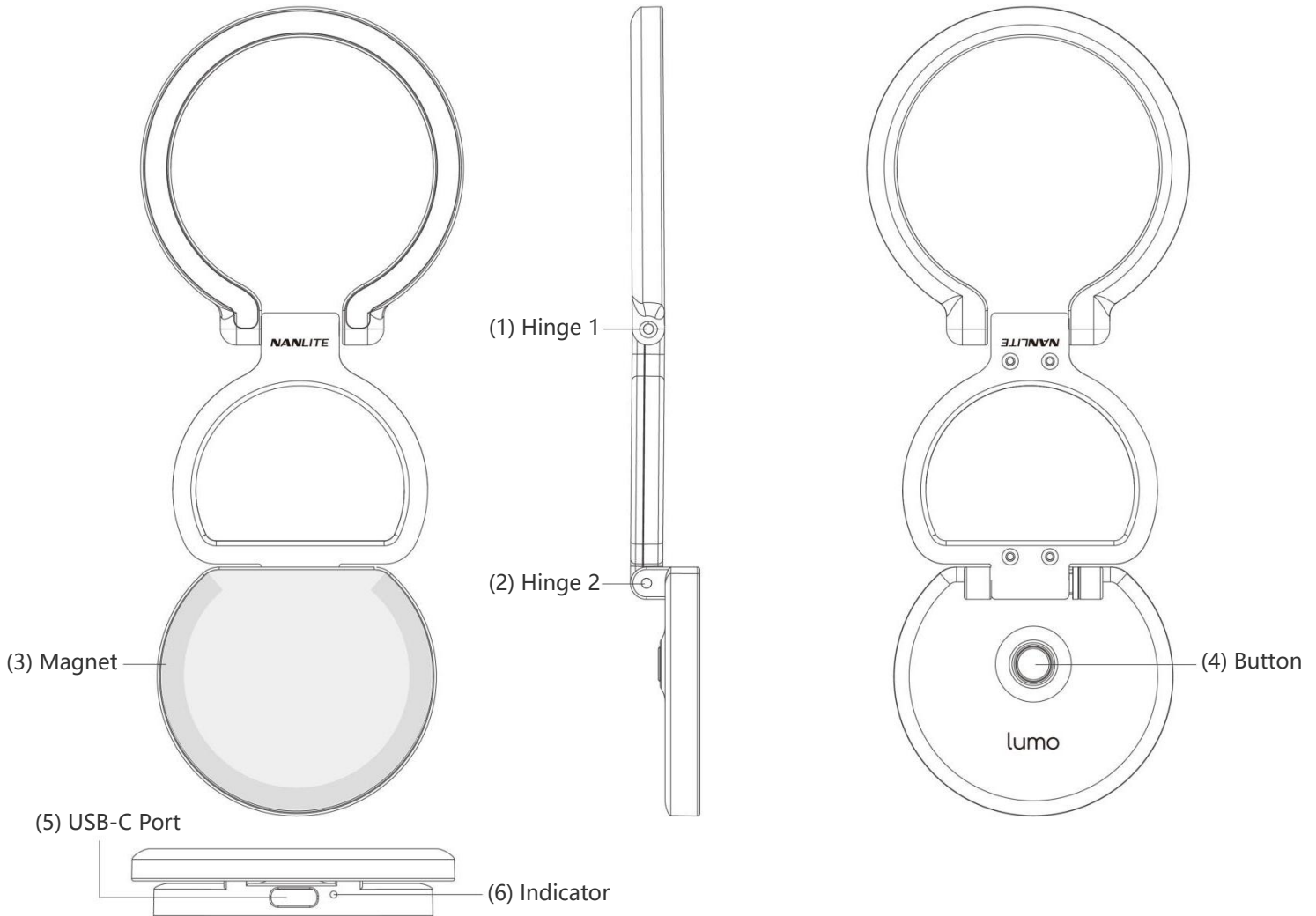

(1) Hinge 1: For adjusting the lighting angle, with a maximum 360° rotation.

(2) Hinge 2: For adjusting the lighting angle together with the hinge 1, with a maximum 180° rotation.

(3) Magnet: For direct attachment (or attachment via magnetic ring) to a phone or other objects.

(4) Button: For turning on/off the fixture, adjusting brightness and color temperature.



(5) USB-C Port: For charging the fixture.

(6) Indicator: For indicating the battery level during use or while charging.

## 2.2. Specifications

Model Name	lumo
Rated Power	0.5W
Input Voltage/Current	DC: 5V/1A
LED Light Engine	WW
CCT	3200K, 4300K, 5600K
CRI	Average 97
TLCI	Average 98
TM-30 Rf	Average 93
TM-30 Rg	Average 100
Control	On-board

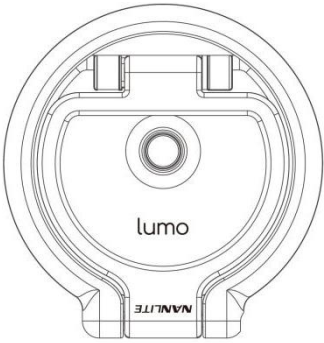
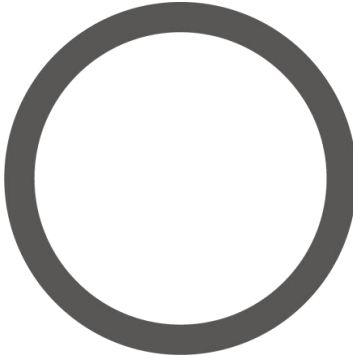
## 2.3. Includes

lumo × 1	Magnetic Ring × 1	User Manual × 1
		

### 3. Safety Instructions

Please read and understand all safety instructions before installing or operating the fixture. Always follow the instructions to avoid personal injury and fixture damage. Retain all safety and operating instructions for future reference.

#### Electrical:



#### Caution

Please use proper and undamaged USB-C cable to connect the fixture correctly, avoiding the risk of electric shock or fixture damage.

#### Operation:



#### Danger

Please do not use the fixture near flammable or explosive materials.



#### Danger

Please keep the fixture away from corrosive liquids or high-pressure steam.

#### Maintenance:



#### Danger

Please do not disassemble or repair any part of the fixture on your own, as this will void the warranty. Maintenance and repair work should be carried out by an authorized service center and professional personnel.



#### Caution

Please ensure that the fixture is completely dry before transportation or storage after using it in a humid environment.



#### Notice

Please ensure the fixture is stored away from the following environments or items: extreme temperatures, direct sunlight, high humidity, intense vibrations, dust, strong magnetic fields, and flammable or explosive materials.



#### Notice

Please recharge the fixture within 24 hours after the battery runs out to prevent long-term discharge.



## 4. Operating Instructions

### 4.1. Magnetic Installation

Attach the fixture to MagSafe-enabled phones, magnetic objects, or use it with the included magnetic ring.

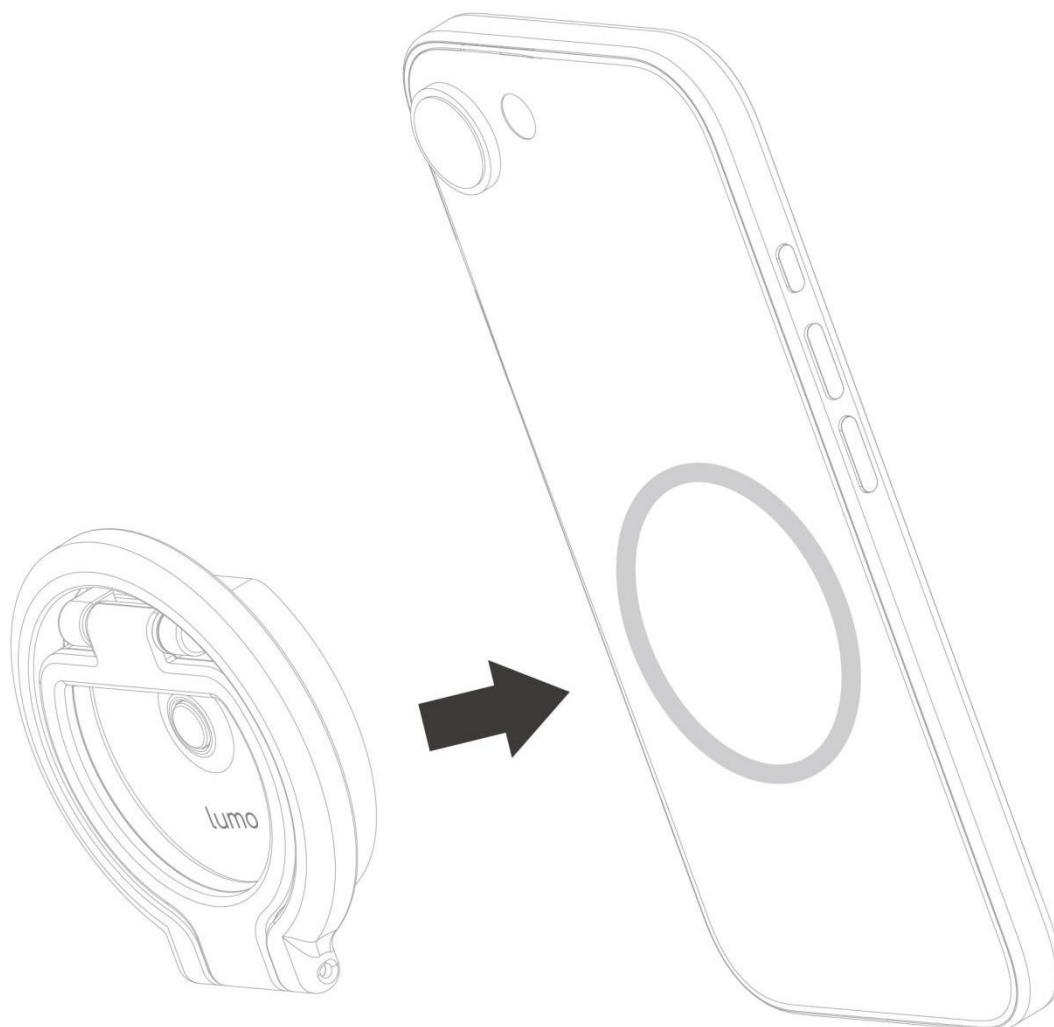

### 4.2. Lighting Control

#### 4.2.1. Brightness Adjustment

The fixture has three adjustable brightness levels: low, medium, and high.

Short press the button to cycle through the brightness levels.

#### 4.2.2. Color Temperature Adjustment

The fixture has three adjustable color temperature levels: 3200K, 4300K, and 5600K.

Press the button for 1s to cycle through color temperatures.

## 4.3. Lighting

### (1) From front camera

Attach the fixture to the back of the phone, rotate the emitting surface to align with the front of the phone as shown below, for front-facing camera lighting.

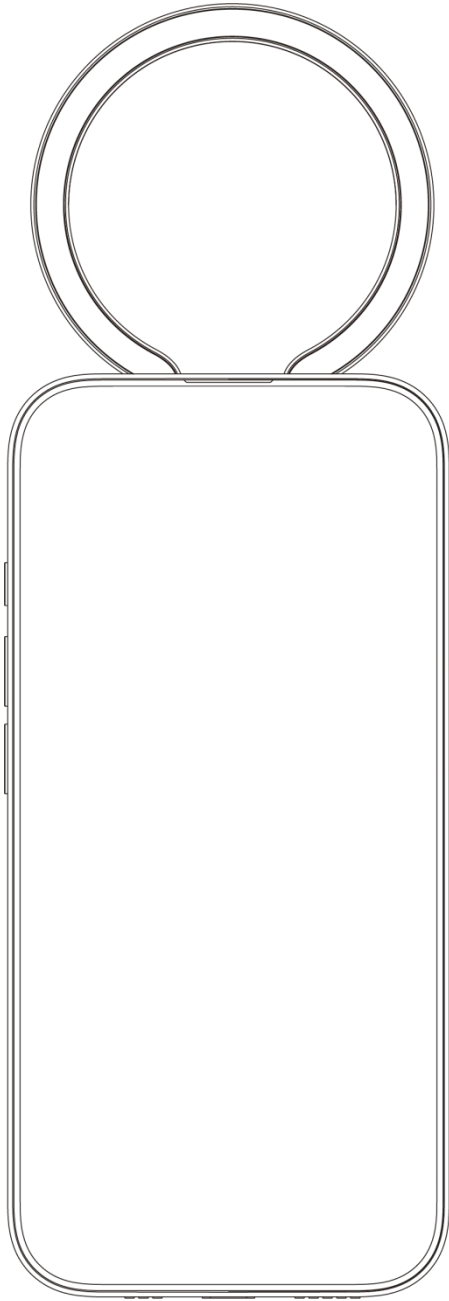

Front View

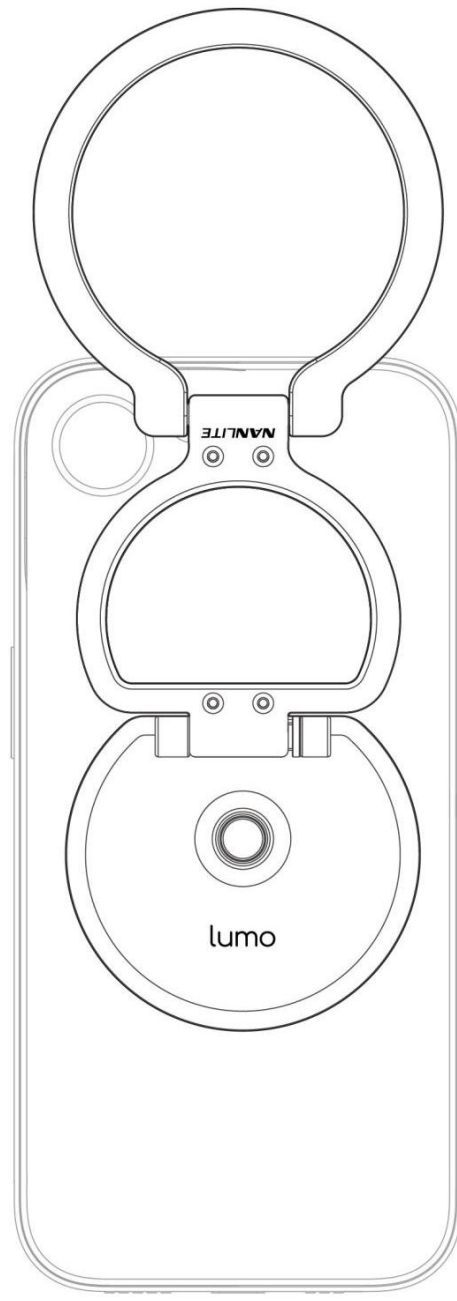

Back View

## (2) From rear camera

Attach the fixture to the back of the phone, rotate the emitting surface to align with the back of the phone as shown below, for rear camera lighting.

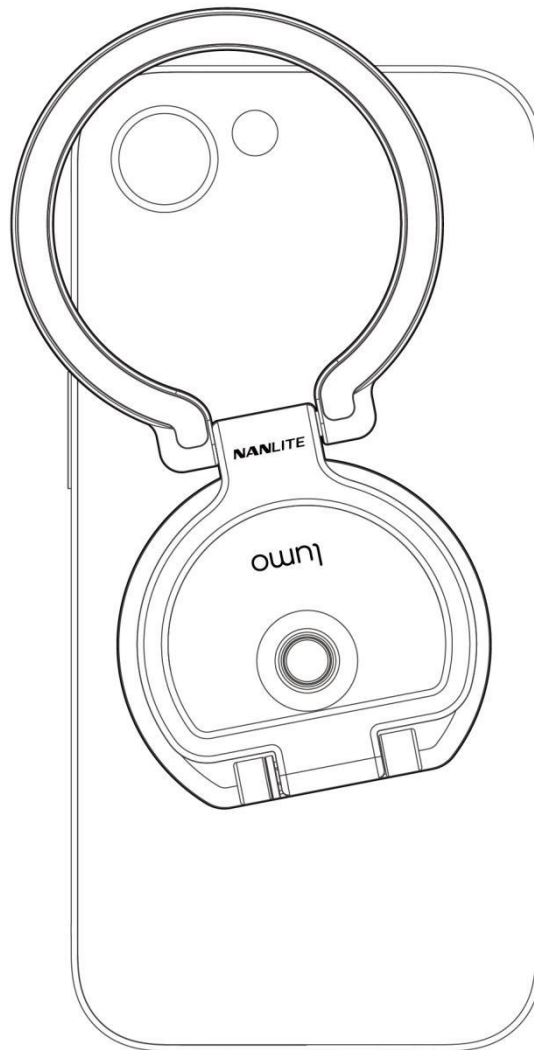

## 4.4. Other Usages

The fixture can also be used as a phone stand. Below are two usage examples for reference:

<p>Method 1: as a phone stand</p>	<p>Method 2: as a phone handle</p>

## 4.5. Charging Instructions

(1) Charge with a charger.

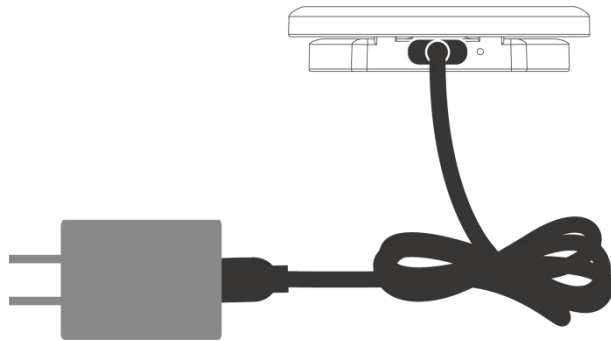

(2) Charge with a power bank.

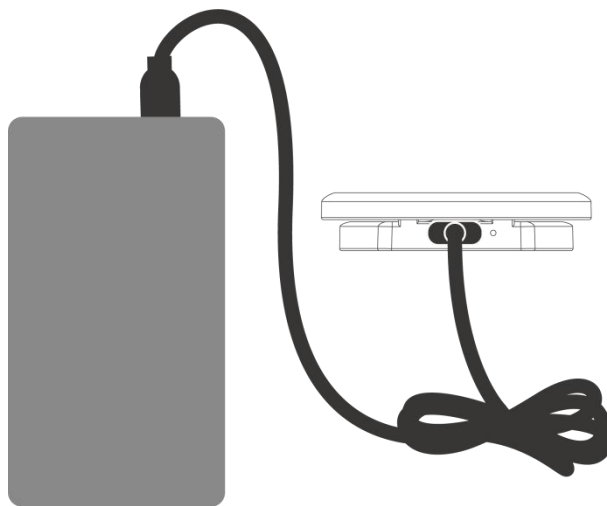

▲ Note: The charger, power bank, and USB-C cable are not included.

## 4.6. Indicator Instructions

The status of the indicator during use and charging corresponds to the battery level:

(1) During use:

- When the button is pressed shortly, and the indicator shows blue light and then dims after 1s, it indicates that the battery level is higher than 25%.
- When the button is pressed shortly, and the indicator shows red light and then dims after 1s, it indicates that the battery level is 25% or lower.
- When the fixture is turned off, if the light blinks 3 times, it indicates that the battery level is lower than 5%.

(2) During charging:

- When the indicator shows a red light with a breathing effect, it indicates that the battery level is 25% or lower.
- When the indicator shows a blue light with a breathing effect, it indicates that the battery level is higher than 25%.
- When the indicator shows a blue light and remains on, it indicates that the battery is fully charged.

## 5. Troubleshooting for Common Issues

Issues	Troubleshooting Guide
The fixture can't power up.	Please check the indicator or connect a USB-C cable to check whether the fixture has power.
The fixture flickers.	Please check whether there are any high-temperature objects nearby that could cause the operating environment temperature to become too high.

**Please scan the QR code for more details**



【Nanlite Website】

WWW.NANLITE.COM

# *NANLITE*

✉ [info@nanlite.com](mailto:info@nanlite.com)

☎ +86-754-85751187

📠 +86-754-85300887

📍 Dongli Section, Highway 324, Chenghai, Shantou City, Guangdong Province, China